

# Installation Instructions for LED Dimmer Switch

Works with DIMMABLE LED, CFL,  
Incandescent and halogen bulbs

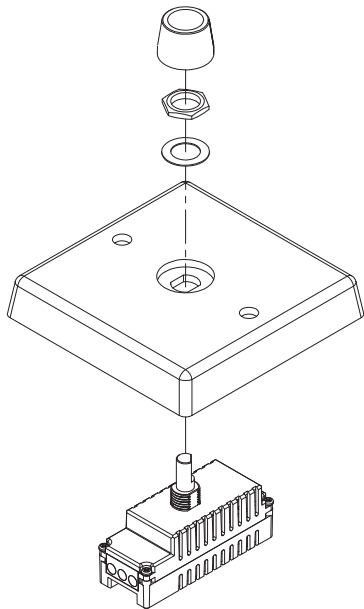

Model No.	T-DUK020M-300
Rated Voltage	220V-240V,50Hz
Rated Wattage	LED:200W INCAN.:300W
Load Range	LED:3W-200W INCAN.:15W-300W
Dimming Mode	Trailing edge control
Compatible Loads	1. Dimmable LED lamp 2. Dimmable LED lamp with electronic transformer 3. Incandescent or medium voltage halogen lamp 4. Low voltage halogen lamp with electronic transformer
Working Temperature	-10°C~40°C
Operation Humidity	10% R.H.-90% R.H.
Installation Wallplate	86mm wallplate

## 1 ⚠ WARNINGS AND CAUTIONS

- Risk of fire and electrical shock, products should be installed in accordance with appropriate electrical codes and regulations.
- This dimmer should be protected by a 6A or up to a 10A maximum miniature circuit breaker
- Turn power off at circuit breaker or fuse and test that power is off before installing.
- After installed the dimmer, it is recommended to set the minimum brightness level to make bulbs turn on immediately.
- If you are unsure about any part of these instructions, consult an electrician.
- To reduce the risk of overheating and possible damage to other equipment, do not install to control a receptacle, a motor-operated appliance or a transformer-supplied appliance.
- Use with compatible dimmable LED, CFL bulbs, Incandescent or halogen fixtures only.
- When multiple bulbs are used with one dimmer DO NOT mix bulb types. All bulbs shall be either LED, CFL or Incandescent. Using the same model of each bulb will enhance dimmer performance.
- Operating at higher temperatures or voltages may cause thermal protection circuit to work. If this happens, decrease the connection load to prevent re-occurrence.

## 2 Functional parts instructions

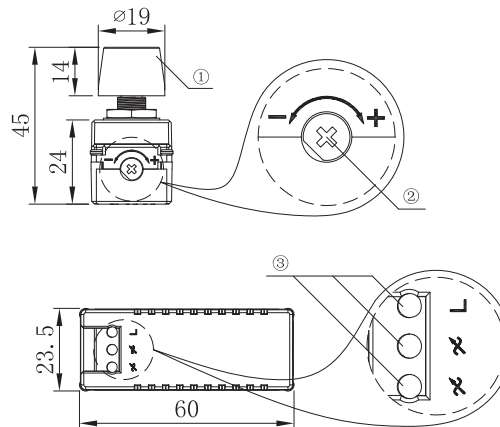

- Push-button Rotary Switch
- Adjustment Button
- Input and Output Terminal

### 2.1 Push-button Rotary Switch①

- 2.1.1 Press the push-button rotary switch① of the dimmer, turn power on or off.
- 2.1.2 Turn clockwise the push-button rotary switch① to increase brightness, turn counter-clockwise to decrease brightness.

### 2.2 Adjustment Button②

- 2.2.1 Turn clockwise the adjustment button② to increase brightness, turn counter-clockwise to decrease brightness.
- 2.2.2 Adjustment button② can adjust and set the minimum brightness level of the bulbs, make bulbs turn on and dimmer with maximum dimming range. Detail see 3.6

### 2.3 Input and Output Terminal③

- 2.3.1 L :Input terminal of the dimmer(connect to "L" hot line)
- 2.3.2 ⚡ :Output terminal of the dimmer(connect to load,namely lamp)

## 3 Installation and testing

### 3.1 Tools needed to install your Dimmer

Φ3mm Slotted Screwdriver	Φ5mm Philips Screwdriver
Test Pencil	Cutters
Electrical Tape	Pliers
Ruler	

3.2 Removing existing switch: Remove existing wall plate and switch mounting screws. Carefully pull switch from wall box, identify and take out the wires attached to the switch, then remove the switch. DO NOT remove wires which are taken out from the switch at this time.(If new configuration is without this step.

3.3 Choose 3.4 or 3.5 one of the connection methods to install your dimmer per your requirement. \*The wire core cross-sectional area of the terminals is 0.75mm<sup>2</sup>-1.5mm<sup>2</sup>, stripping length is 8mm.

### 3.4 1-Way Wiring Application

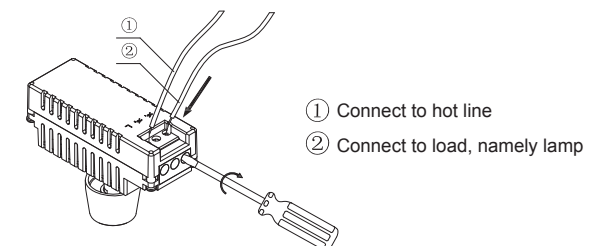
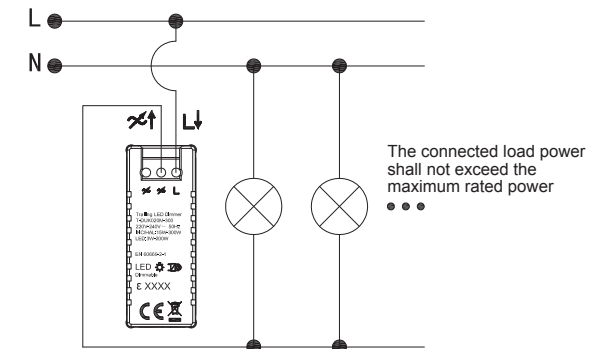

3.5 2-Way Wiring Application

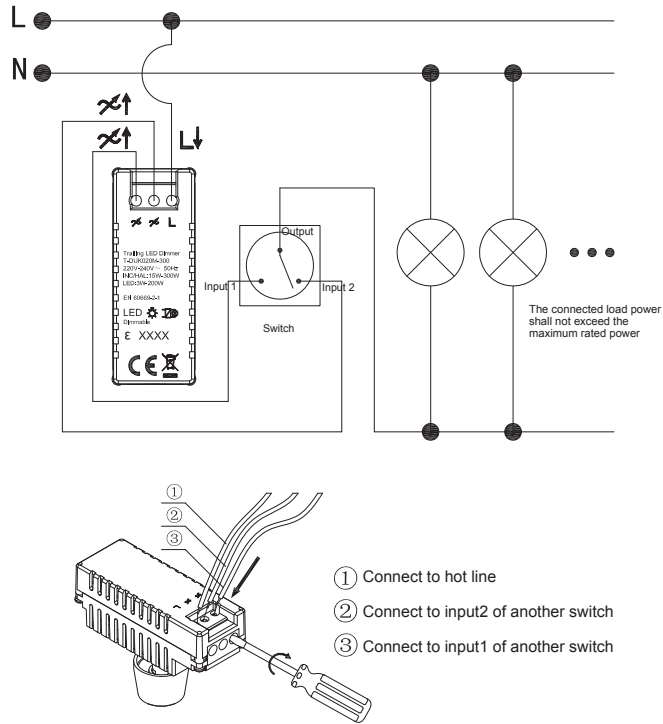

**IMPORTANT:** In a 2-way circuit, only one dimmer can be used.

3.6 Testing

NOTE: Dimming range of dimmable LEDs can vary from manufacturer to manufacturer. If your bulbs do not dim to your satisfaction, especially the dimmer range and minimum brightness level, adjust the adjustment button of the dimmer after installed can get desired lighting result (The product is designed with an adjustment button). Functional parts instructions see 2, detail testing see below.

- 3.6.1 Press the rotary switch ① of the dimmer, and turn clockwise to make bulbs work, then turn counter-clockwise the rotary switch to the lowest level.
- 3.6.2 Turn counter-clockwise ("−") the adjustment button ② to lowest desired brightness level where light output for all bulbs is stable and does not flicker or flash.
- 3.6.3 Turn off the rotary switch ① and then back on rotary switch ① after 1s. Verify that all bulbs turn on and stable, do not flicker or flash.
- 3.6.4 If all or some bulbs do not turn on or do not satisfy to your minimum brightness level, turn clockwise ("+") the adjustment button ② slightly to make all bulbs work and repeat step 3.6.2 and 3.6.3.

3.6.5 After the above setting then can make the bulbs startup with the minimum brightness level when turn on dimmer and the rotary switch ① with maximum dimming range.

3.7. Installing wall plate

3.7.1 Take out the metal gasket, hex nut and knob from the dimmer.

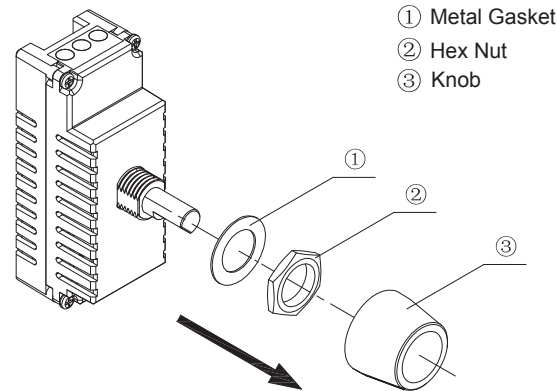

3.7.2 Fix the dimmer on the wall plate, then fix the metal gasket and hex nut orderly on the wall plate, install the knob finally, gently push it to ensure flush fit.

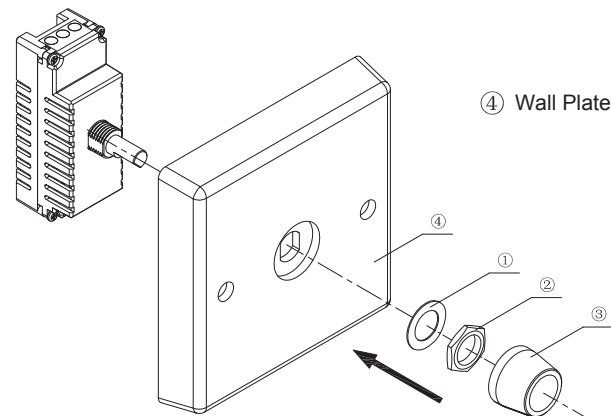
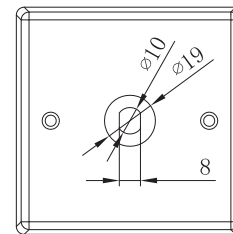

3.7.3 Carefully position all wires inside the junction box, leaving enough room to insert the dimmer housing. Put the dimmer into the junction box and fix it using screws.

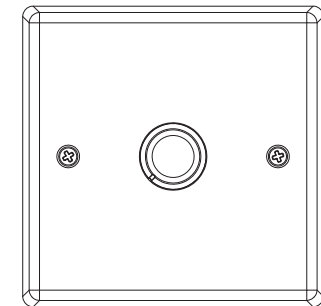
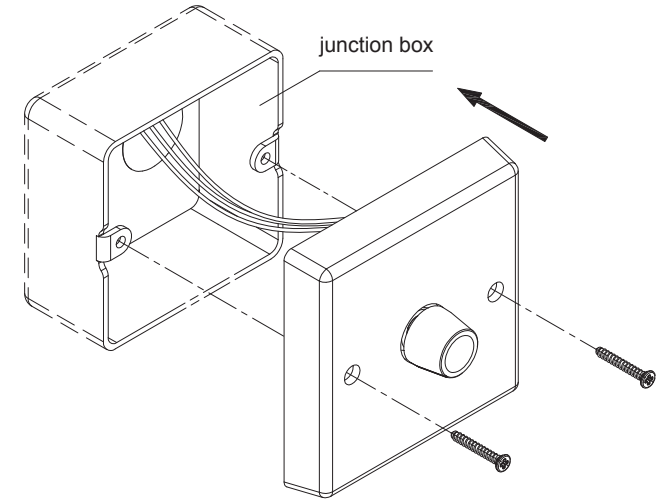

4 Troubleshooting

Problem	Possible Cause	Solution
Lights flickering	Lamp has a bad connection	Reconnect and fix the wires
LED and CFL flickers at low end of dimming range	Adjust the adjustment button	Detail see 3.6
Light does not turn on	Circuit breaker has tripped	Turn power on
	Fuse burn out	Change fuse
	Lamp burned out	Change lamp
	Lamp neutral connection is not wired	Reconnect the lamp neutral