

TRAN-L-DMX-CSB

Technical Datasheet for DMX (Input) to Casambi Translator



Description

The TRAN-L-DMX-CSB is a System Protocol Translator. With this device you can use any DMX inputs as an input for your Casambi network, including DMX Switches, Mixing Tables and Head-End Devices.

Capable of streaming a maximum of 8 DMX Addresses as input to Casambi.

- 12-48 VDC Input
- 8 Assignable DMX Input Addresses
- Stream DMX Effects or Integrate DMX Wall Switches into Casambi
- Configurable In-App (No need for DMX Commissioning)
- Casambi Long-Range
- Remote Antenna Configuration Available
- 200 Meter Wireless Range (Casambi Long-Range Mode)*

**CASAMBI**

Technical Specifications

Mechanical

| | |
|------------|-------------------------------------|
| Housing | Black Plastic Injection Moulded ABS |
| Dimensions | 103mm x 35mm x 28mm |
| Weight | 52g |
| Protection | IP20 |
| Mounting | Screwdown |

Power Input

| | |
|---------------|--------------------|
| Voltage Range | 12-48VDC |
| Max Current | 6mA@48V 16mA@12V |

DMX Input

| | |
|------------------------|---|
| DMX Input | DMX512 protocol using 3.3-5V RS422, Input Galvanically Isolated |
| Max Assigned Addresses | 8 - Others may be sent but will be ignored |

Radio Transceiver

| | |
|-----------------------|---|
| Operating Frequencies | 2.4Ghz - 2.483Ghz |
| Maximum Output Power | +8 dBm |
| Wireless Protocol | Casambi Wireless Mesh |
| Wireless Range | 75 Meters (200 Meters in Casambi Long-Range Mode) |

Operating Conditions

| | |
|------------------------|--------------------|
| Ambient Temperature | 0°C to +50°C |
| Max. Case Temperature | +75°C |
| Storage Temperature | -40°C to +80°C |
| Max. Relative Humidity | 80% non-condensing |

Connectors

| | |
|-------------------|---------------|
| Wire Range | 0.2mm - 1.5mm |
| Wire Strip Length | 5mm |

Dimensions

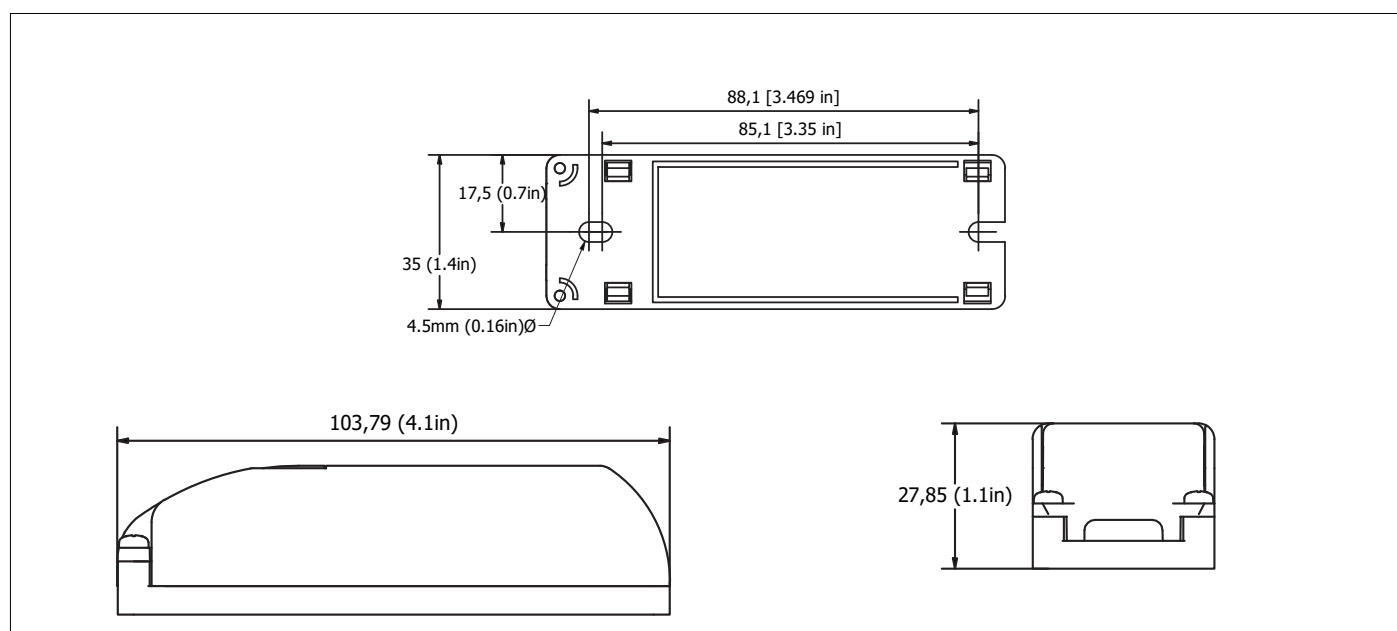

Wiring Diagram

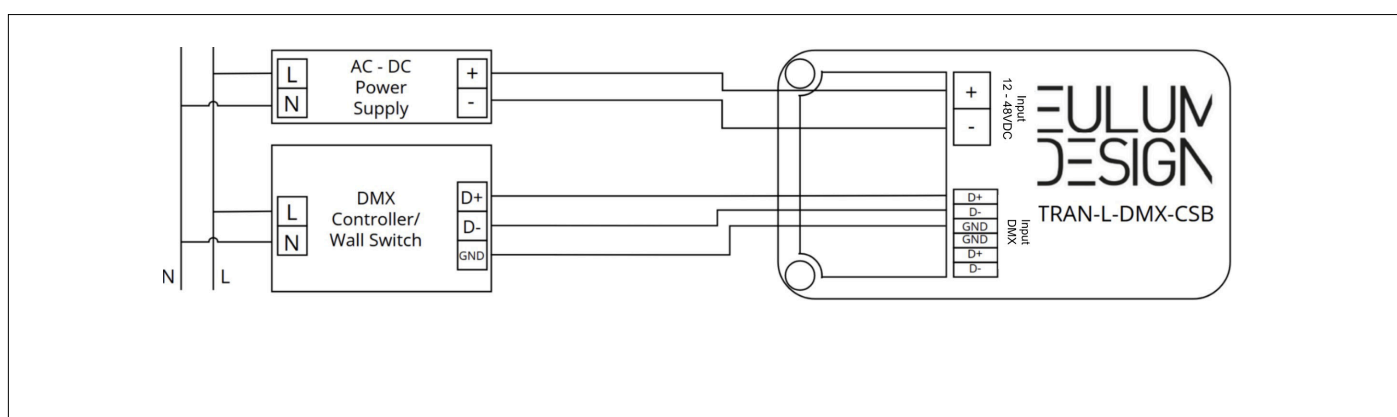

*Range

In open air, the wireless range can reach up to 200m in Long-Range mode. This may be reduced when placed inside a building, or by other environmental factors. In normal mode, the range is up to 75m.

Please note that putting the unit inside a metal enclosure is unadvised as this will dramatically reduce the signal range.

Compatible Devices:

iPhone iOS and later are supported

iPad iOS 10 and later are supported

Android 4.4 version (KitKat) and later are supported.



Warranty

For information on our warranty, please visit: www.eulum.com/warranty/

Profiles

| Profile Name | Description |
|----------------|---|
| TRAN-L-DMX-CSB | 8 Address, Configurable DMX to Casambi 'Switch' |

Device Settings

Parameters View

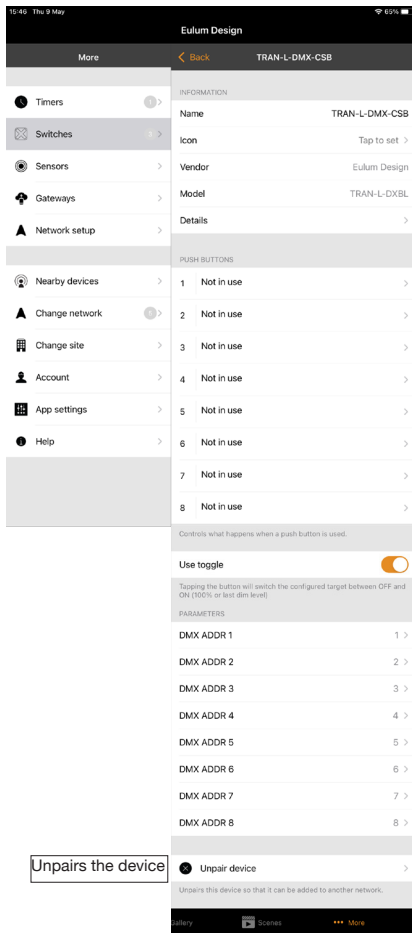

'Push Buttons'
 Here we can assign what actions will occur when the device receives a command. In Casambi, each received broadcast of an address is considered a button press. As this device supports 8 DMX addresses, this is represented by 8 push buttons. Selecting any of these 'buttons' will take you to the Button Configuration view (right), where you may assign an action to the address.

In the Parameters section, we can assign which DMX addresses will activate a 'push button'. Each address is assigned to 1 of the buttons above, for example DMX ADDR 1 is mapped to button 1. Selecting any of these items will open the DMX Address Assignment view (shown below), where you may assign it a specific DMX address.

Unpairs the device

Enables/Disables Toggle Feature

Button Configuration

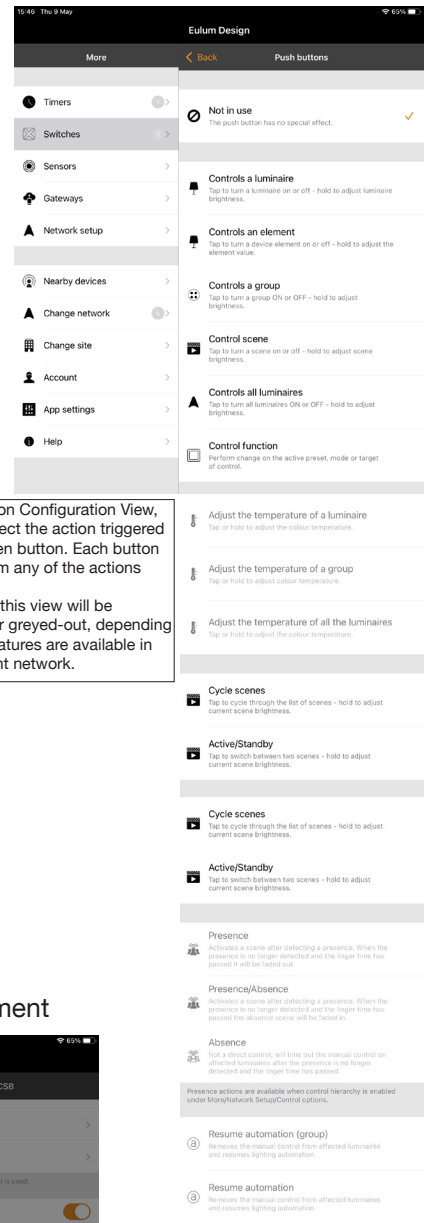

In the Button Configuration View, we can select the action triggered by any given button. Each button can perform any of the actions seen here. Options in this view will be available or greyed-out, depending on what features are available in your current network.

DMX Address Assignment

